

76'-9"

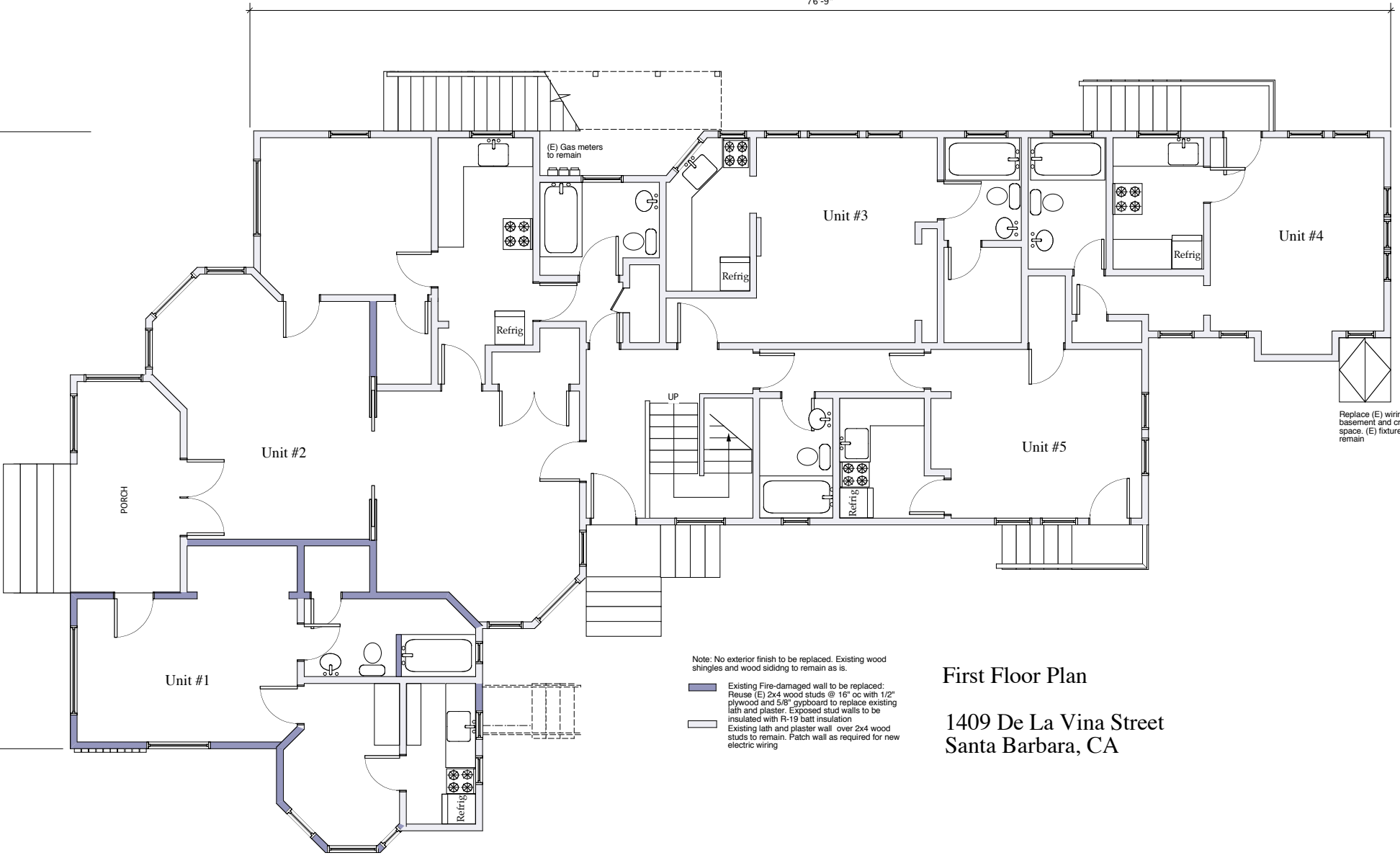

Note: No exterior finish to be replaced. Existing wood shingles and wood siding to remain as is.

- Existing Fire-damaged wall to be replaced: Reuse (E) 2x4 wood studs @ 16" oc with 1/2" plywood and 5/8" gypboard to replace existing lath and plaster. Exposed stud walls to be insulated with R-19 batt insulation
- Existing lath and plaster wall over 2x4 wood studs to remain. Patch wall as required for new electric wiring

Replace (E) wiring in basement and crawl space. (E) fixtures to remain

First Floor Plan
1409 De La Vina Street
Santa Barbara, CA